



KONICA MINOLTA

BUILT FOR GROWING BUSINESS

A3 Monochrome bizhub 367 series



bizhub 367/287

Giving Shape to Ideas

Business needs are changing with the smart proliferation of smart devices and cloud usage. The new monochrome bizhub 367 series provides the latest technology and is designed for business that requires connectivity, functionalities, good user experience and productivity.

Business users can expect improved efficiency, reduced energy consumption and smaller hardware footprint. The new series are also packed with the latest security technology.

The new bizhub 367 series comes with an intuitive 7-inch control panel. Its on-screen soft menu keys and hard menu keys allow users to register up to 9 commonly used functions.



AirPrint

Apple's standard printing system compatible with iOS 4.2 and Mac OS 10.7 or later. A compatible printer on your wireless LAN can be used.



Mopria Print Service

Wireless printing technology established by Mopria Alliance. It allows you to print from devices installed with Android 4.4 or later.



Google Cloud Print

A cloud print service provided by Google. User can print from any location via the internet regardless of OS or device type.



Konica Minolta Print Services

Print directly to bizhub via a wireless LAN from all apps that support Android's print function.



PageScope Mobile

Konica Minolta's proprietary mobile print application allows usage of wide range of bizhub functions such as duplex print, security print, staple and punch.

¹ Android devices must be installed with Android 4.4 or later and NFC Antenna that supports HCE (Host Card Emulation). For iOS devices, iPhones4s or later, 3rd generation or later iPad and iPad mini are compatible with Bluetooth LE.

² Optional Device Connection Interface Kit EK-609 is required.

³ Google Cloud Print Setup and Google account registration are required. Optional Upgrade Kit UK-211 is required.



The new series supports mobility that allows users to scan and print with Near Field Communication¹ (NFC) or Bluetooth LE² and the standard mobile print technologies such as Google Cloud Print³, Apple AirPrint and Mopria Print Service; alongside Konica Minolta proprietary mobile print technologies like Konica Minolta Print Service and Konica Minolta PageScope Mobile. It allows information-sharing and document management through Cloud services where users can scan to Cloud and Print from Cloud.



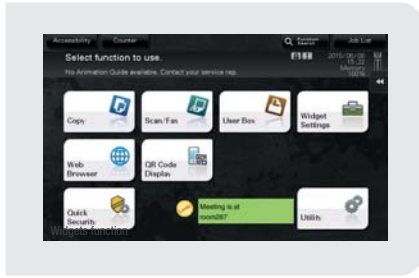

Equipped with latest MFP controller architecture, the bizhub 367 series has standard web browser. The newly developed control panel allows the use of multi-touch UI to display, print and distribute website or content.

With the improved Auto Refine Development Technology, users can expect enhanced image quality.

The new bizhub 367 series comes with embedded widget application where users can install and execute within the MFP operation panel. Text boxes, icons or GIF animations can be installed and used for internal communication such as messages and rules.

SECURITY FEATURES

The bizhub 367 series' main controller conforms to IEEE standard 2600.1 – 2009^{*1} and it is equipped with TPM^{*2} (Trusted Platform Module) to protect confidential information. It enhances security by completing the encryption process within the chip for a safer encryption process.

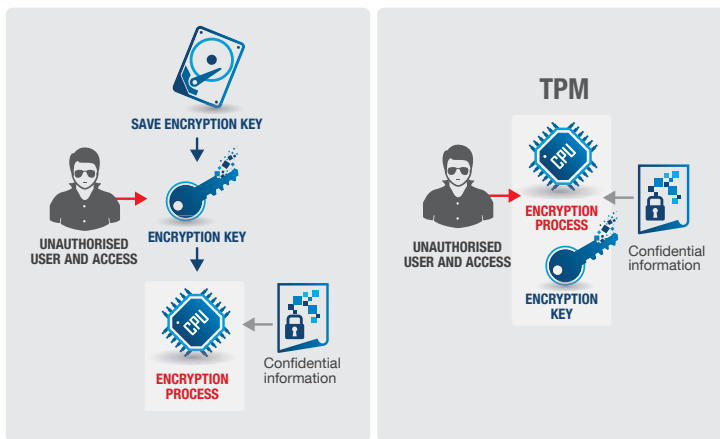

Previous encryption process

Encryption process with TPM

*1 currently under application for ISO/IEC 15048

*2 Optional i-Option LK-115 v2 is required

SERVER-LESS PULL PRINTING

With server-less pull printing, print jobs sent by users can be printed from any MFP in the same network.

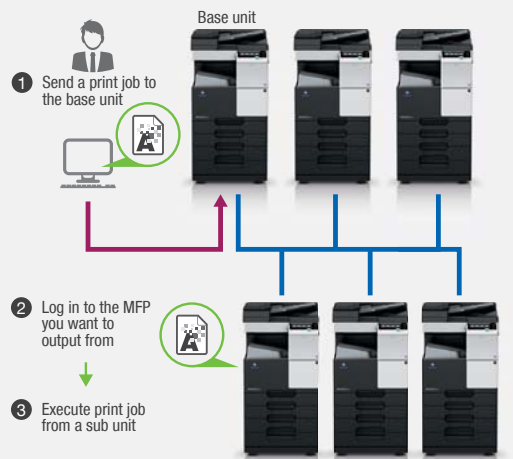

* A pull printing system supports up to a maximum of 10 MFPs. It is necessary that all corresponding MFPs to be in the same network.

* Options required
 Base unit : LK-114 + UK-211 + HD-522
 Client unit (Web Browser OFF) : LK-114 + UK-211 + HD-522
 Client unit (Web Browser ON) : LK-114

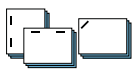
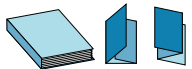

FINISHING OPTIONS

The new bizhub 367 series supports a wide range of finishers for various types of output. Users can create and produce a variety of printed materials in-house which will lead to more flexibility and productivity.

 <p>Stapling function</p>	 <p>Binding (booklet) & Folding functions</p>	 <p>Punching function</p>	 <p>Cover sheet & paper insertion functions</p>
--	--	--	--

> GREEN

The bizhub 367 Series has been awarded the International Energy Star Program Version 2.0 (revised in January 1, 2014).

Users can monitor and implement green initiatives by adding shortcut keys for Eco function such as toner/ paper saving or power saving on the control panel.

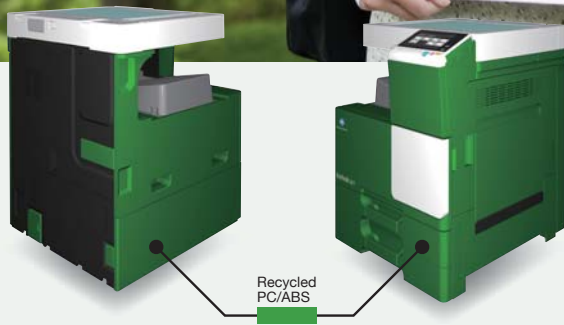

**Environmental
contribution is
always the
TOP PRIORITY**

Top class power consumption and TEC value in its class

The MFP's CPU power is set to turn off during sleep mode. This results in a top class 0.5 W power consumption ratio (during sleep mode). The TEC value has also been reduced approximately by 32-55%. Less CO₂ emissions from MFP.

* Values for 220-230 V

* TEC values applied to the International Energy Star Program Version 2.0

Yearly CO₂ emissions:
TEC value × 52 weeks × emission factor
(From the November, 2011 press release by Japan's Ministry of the Environment.)

Usage of the recycled materials

Recycled PC/ABS and biomass plastic have been used in the MFP body. The recycled material usage is approximately 11% of total MFP weight ratio¹ and approximately 51% of the MFP main body are made by the recycled materials.

¹ Total weight ratio of resins and plastics used in this machine.

bizhub 367/287

Black & White:
36 / 28 ppm

MAX Paper
Capacity:
3,600 sheets

Scanning speed:
45 opm*

* When using the Reverse Automatic Document Feeder DF-628 (optional)

Print Resolution:
1800x600 dpi



Key Features:

Print Speed A4: 36 / 28 ppm in black & white

Paper formats: A6-A3, postcard, envelope, label sheet, tab paper

7-inch colour touch panel with multi-touch support

Modular finishing and paper tray options for customised configurations



¹ Optional

² Available from Fall 2015

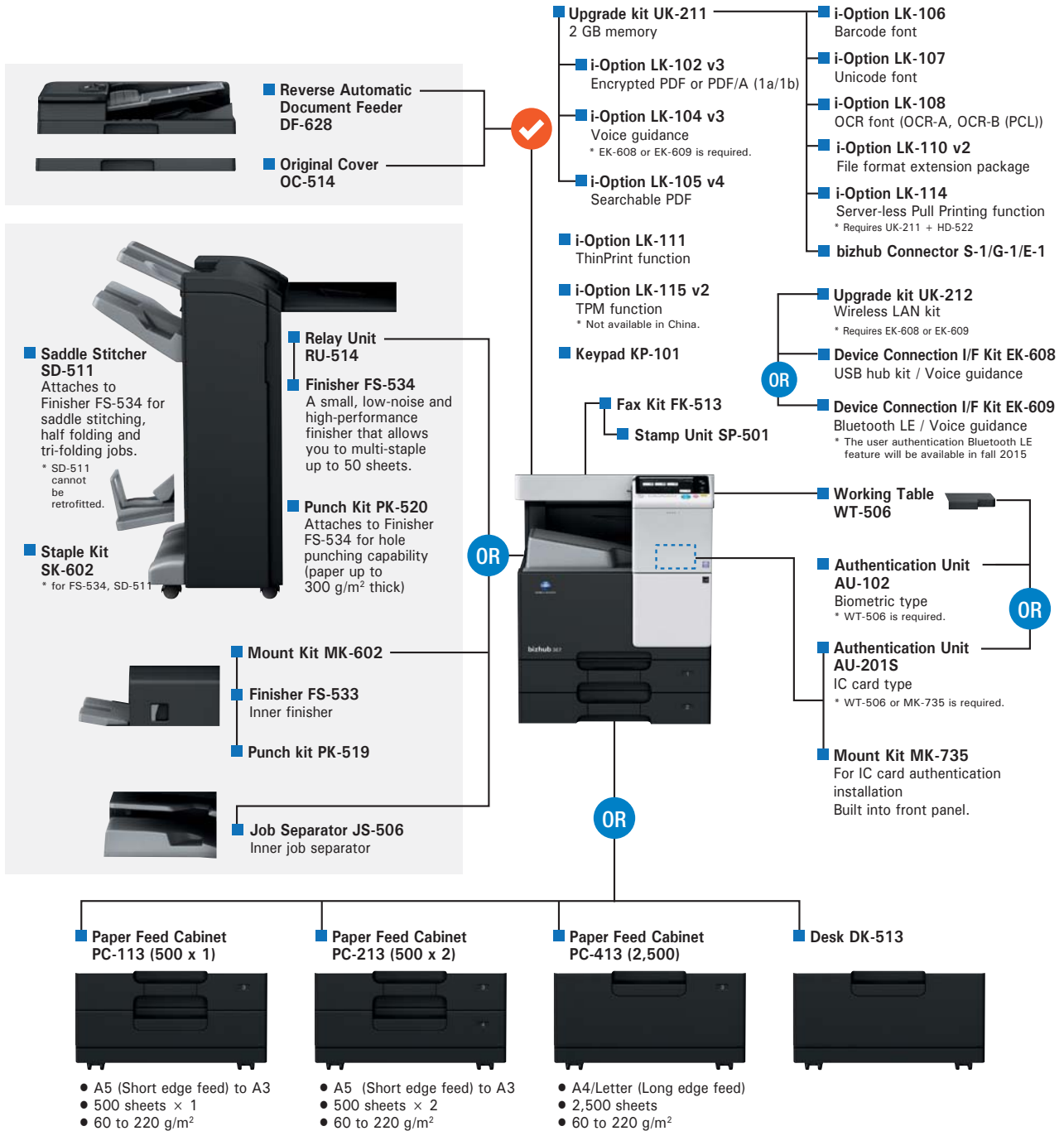

Note: Some options are not listed.



One of the options may be selected (not mandatory).



One of the options must be selected (mandatory).

SPECIFICATIONS - bizhub 367/287

bizhub 367/287 General Specifications

		bizhub 367	bizhub 287
Type		Desktop Printer / Copier / Scanner	
Copy Resolution	Scan	Main: 600 dpi Sub: 600 dpi	
	Print	1,800 dpi (equivalent) 600 dpi	
Gradation		256	
Memory Capacity (Std./Max.)		2 GB/4 GB	
HDD		250 GB (optional)	
Original Type		Sheets, Books, Objects	
Max. Original Size		A3 (11" x 17")	
Output Size		Main unit: A3 to A5, 11" x 17" to 8-1/2" x 11", 5-1/2" x 8-1/2", 8" x 13" ¹ , 16K, 8K Bypass Tray: A3 to A5, B6 ² , A6 ² , 11" x 17" to 5-1/2" x 8-1/2", 8" x 13" ¹ , 16K, 8K, Postcard (A6 (4" x 6" Card)), Envelope ³ , Label sheet, Tab paper	
Image Loss		Max. 4.2mm or less for top edge (5 mm for thin paper), Max. 3.0mm or less for bottom edge, Max. 3.0mm or less for right/left edges ¹ A loss of 4.2 mm each during printing.	
Warm-Up Time ⁴ (23 C, std. voltage)		20 sec. or less	
	⁴ The time required to start printing when both the main power and sub-power switches are turned from OFF to ON.		
	⁵ The time required to start printing when the main power switch is ON and the sub-power switch is turned from OFF to ON.	15 sec. or less	
First Copy Out Time ⁶		4.5 sec. or less	5.3 sec. or less
Copy Speed (A4)		36 ppm	28 ppm
Copy Magnification	Fixed Same Magnification	1: ±0.5% or less	
	Scaling Up	1: 1.154/1.224/1.414/2.000	
	Scaling Down	1: 0.866/0.816/0.707/0.500	
	Preset	3 types	
	Zoom	25 to 400% (in 0.1% increments)	
	Lengthwise Crosswise Individual Settings	25 to 400% (in 0.1% increments)	
Paper Capacity (80 g/m ²)	Tray 1	500 sheets (up to B4)	
	Tray 2	500 sheets (up to A3)	
	Multiple Bypass Tray	100 sheets (up to A3)	
Max. Paper Capacity (80 g/m ²) ⁶		3,600 sheets	
Paper Weight	Tray 1 / 2	60 to 220 g/m ²	
	Multiple Bypass Tray	60 to 220 g/m ²	
Multiple Copy		1 to 9,999 sheets	
Auto Duplex	Paper Size	A3 to A5 ⁷ , B5 ⁷ , 11" x 17" ² to 5-1/2" x 8-1/2" ² , 7-1/4" x 10-1/2", 8" x 13" ² , 16K, 8K ²	
	Paper Weight	60 to 209 g/m ²	
Power Requirements		AC230 V 7 A (50 to 60 Hz)	
Max. Power Consumption		1.5 kW or less	
Dimensions [W] x [D] x [H]		585 x 660 x 735 mm (23-1/16" x 26" x 28-15/16")	
Weight		Approx. 56.5 kg (124-1/2 lb)	
Space Requirements [W] x [D] ⁸		899 x 1,172 mm (35-1/2" x 46-1/4")	

¹ There are six types of foolscap: 8-1/2" x 13-1/2"², 220 mm x 330 mm², 8-1/2" x 13"², 8-1/4" x 13"², 8-1/8" x 13-1/4"², and 8" x 13"². Any one of these sizes is selectable. For details, contact your service representative.

² Short edge feed 

³ Wrinkles or printing errors may occur due to the type, storage or environment that exists when envelope printing is carried out.

⁴ May vary depending on the operating environment and usage.

⁵ A4 long edge feed full size/using the first tray/scanning from the original glass surface.

⁶ With options installed.

⁷ Long edge feed 

⁸ Without options, with paper trays pulled out and multiple bypass tray open.

Printer Specifications

Type		Embedded
CPU		ARM Cortex-A7 Dual-core 1.2GHz
Memory		Shared with the copier
Print Speed		Same as Copy Speed (when using the same original)
HDD		250 GB (Shared with the copier)
Print Resolution		1,800 dpi (equivalent) 600 dpi
PDL		PCL 6, PostScript 3 Emulation, XPS
Protocol		TCP/IP, IPX/SPX (NDS support), SMB (NetBEUI), LPD, IPP1.1, SNMP, AppleTalk
Support OS		Windows Vista ¹ / 7 ¹ / 8 ¹ / 8.1 ¹ Windows Server 2003 ¹ / 2003 R2 ¹ / 2008 ¹ / 2008 R2 / 2012 / 2012 R2 Mac OS X (10.6 / 10.7 / 10.8 / 10.9 / 10.10) Linux
Fonts	PCL	80 Roman fonts
	PS	137 Roman Type1 fonts
Interface		Ethernet (10BASE-T/100BASE-TX/1000BASE-T), USB 1.1, USB 2.0, IEEE 802.11 b/g/n ²

¹ Supports the 32-bit (x86) or 64-bit (x64) environment.

² Optional

Scanning Specifications

Type		Full-Colour Scanner
Interface		Ethernet (10BASE-T/100BASE-TX/1000BASE-T), IEEE 802.11 b/g/n ¹
Driver		TWAIN Driver, HDD TWAIN Driver
Protocol		TCP/IP (FTP, SMB, SMTP, WebDAV) (IPv4/IPv6)
Scanning Speed (Colour/B&W) (300 dpi, A4, Simplex)		45 opm ²
Scanning Size		Max. A3 (11" x 17")
Output Format		TIFF, JPEG, PDF, Compact PDF, XPS, Compact XPS, OOXML (pptx, xls ¹ , docx ¹), Searchable PDF ¹ , PDF/A ¹ , Linearised PDF ¹
Scanning Resolution	Push	200 dpi / 300 dpi / 400 dpi / 600 dpi
	Pull	100 dpi / 200 dpi / 300 dpi / 400 dpi / 600 dpi
Main Functions		Scan to E-Mail, Scan to FTP, Scan to BOX (HDD), Scan to PC (SMB), Network TWAIN, Scan to WebDAV, Scan to USB, Scan to Scan Server, Scan to Web Service (WSD-Scan), Device Profile for Web Services (DPWS)
Other Functions		Multi-Method Send, Authentication at the time of E-Mail send (SMTP authentication, POP before SMTP), S/MIME, Annotation

¹ Optional

² When using the Reverse Automatic Document Feeder DF 628.

Internet Fax

Protocol		TX: SMTP, RX: POP3, TCP/IP Simple mode
Connection Mode		Full-Mode
Sending Paper Size		A3, B4, A4
Recording Paper Size		Max. A3
Resolution		B/W: 200 x 100 dpi, 200 x 200 dpi, 400 x 400 dpi, 600 x 600 dpi Colour: 200 x 200 dpi, 400 x 400 dpi, 600 x 600 dpi
Interface		Ethernet (10BASE-T/100BASE-TX/1000BASE-T)
Colour		Support Colour Internet Fax
Format		B/W: TIFF-F Colour: TIFF (Conforms to RFC3949 Profile-C)

Fax Kit FK-513 (Optional)

Communication		Super G3
Compatible Lines		Public Switch Telephone Network, Private Branch Exchange, Fax Communication Line
Line Density		Ultra Fine: 600 dpi 600 dpi
		Super Fine: 16 dot/mm 15.4 line/mm, 400 dpi 400 dpi
		Fine: 8 dot/mm 7.7 line/mm, 200 dpi 200 dpi Normal: 8 dot/mm 3.85 line/mm
Modem Speed		2.4 to 33.6 kbps
Compression		MH/MR/MMR/IBIG
Sending Paper Size		Max. A3 (Long Length Support: Max.1,000 mm)
Recording Paper Size		Max. A3 (Long Length Max. 1,000 mm — following the page division —)
Transmission Speed		Less than 2 sec. (A4, V.34, 33.6 kbps, JBIG)
Memory		Shared with the copier
Number of Abbr. Dials		2,000
Number of Program Dials		400
Number of Group Dials		100
Sequential Multiple Station Transmission		Max. 600

IP Address Fax ¹Optional Fax Kit FK-513 is required.

Protocol Transmission		TCP/IP, SMTP
Sending Paper Size		A3, B4, A4
Resolution		200 x 200 dpi, 400 x 400 dpi, 600 x 600 dpi
Format		B/W: TIFF-F, TIFF-S Colour: TIFF, PDF



Reverse Automatic Document Feeder DF-628 (Optional)

Type		Circulatory duplex system
Support Paper Size		Max. A3 (Fax mode: Max. 1,000 mm)
Mixed Size		Support
Original Set		Centre guide
Support Paper Weight		Simplex: 35 to 128 g/m ²
		Duplex/Mixed Original: 50 to 128 g/m ²
Paper Capacity		Max. 130 sheets (68 g/m ²)
Productivity (A4)		300 dpi simplex 45 opm 600 dpi simplex 36 opm
		300 dpi duplex 22 opm 600 dpi duplex 17 opm
Power Requirements		Supplied from the MFP main body
Dimensions [W] x [D] x [H]		585 x 504 x 127 mm (23" x 19-3/4" x 5")
Weight		Approx. 9 kg (19-3/4lb)



FOR THE EARTH. FOR THE FUTURE.

KONICA MINOLTA BUSINESS SOLUTIONS (M) SDN BHD (72640-P)

Infinite Centre, Lot 1, Jalan 13/6, 46200 Petaling Jaya, Selangor, Malaysia.

Contact Us:

Sales & Marketing:

Tel : +603-7801 2611/ 7966 1000

Fax: +603-7954 8316

Email : marketing.1@konicaminolta.com

Technical Support:

National Service Contact Center: 1-300-Call-KM (2255-56)

www.konicaminolta.com.my/business